

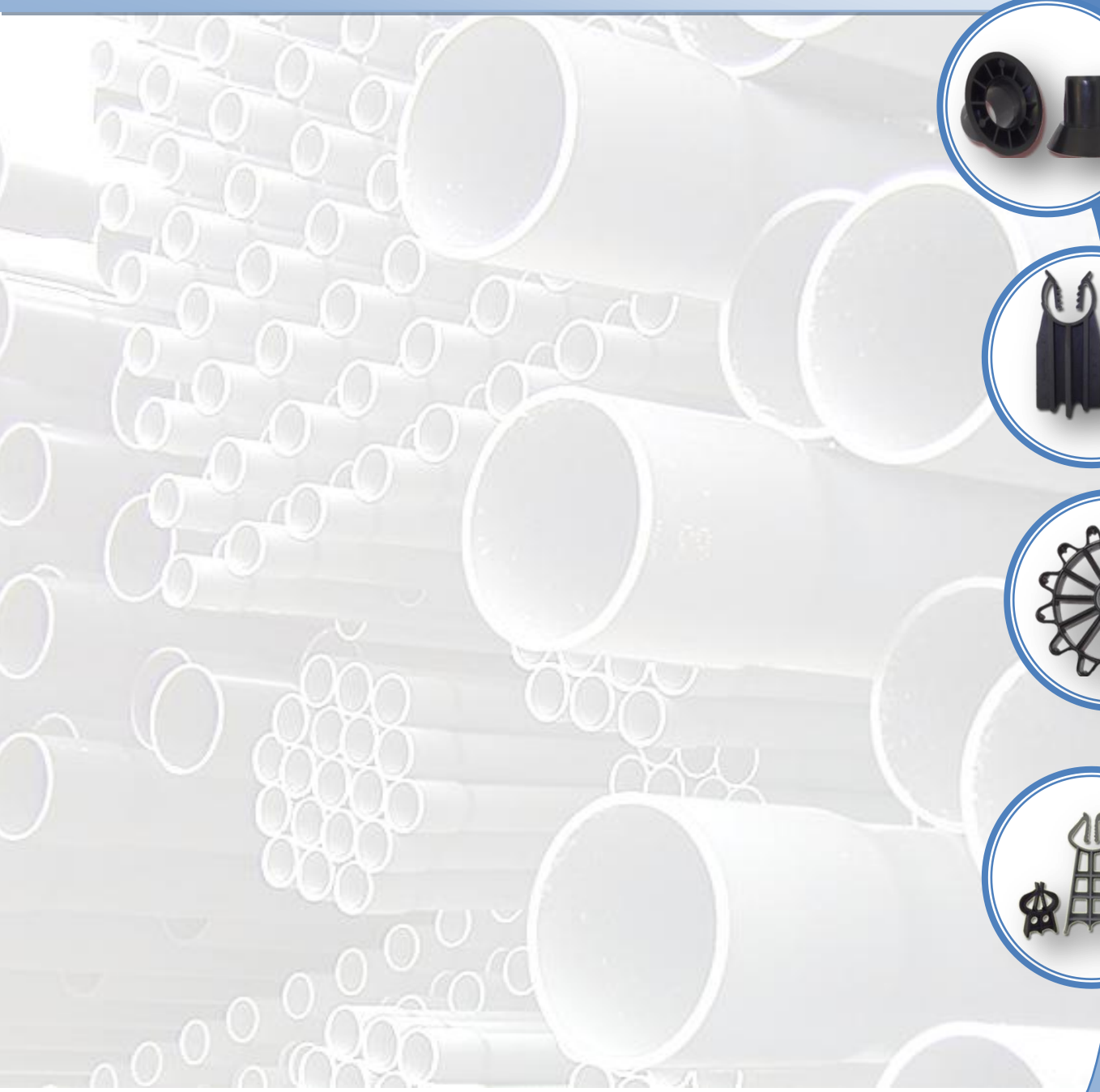

# Modern Building Accessories Factory





## Clip Spacer (MC)

Product Code	Item Description	Concrete Cover (mm)	For Steel Bar Diameter (mm)	Packing Quantity per Bag (pcs)
<b>MBA-MC20</b>	Clip Spacer MC 20	20	4-16	2,000
<b>MBA-MC25</b>	Clip Spacer MC 25	25	4-20	1,000
<b>MBA-MC30</b>	Clip Spacer MC 30	30	4-20	1,000
<b>MBA-MC40</b>	Clip Spacer MC 40	40	4-20	500
<b>MBA-MC50</b>	Clip Spacer MC 50	50	4-20	500
<b>MBA-MC75</b>	Clip Spacer MC 75	75	10-32	250

**Application** A medium plastic chair spacer, designed for supporting a minimum load of 100kg according to German performance class L2 (1KN). The clips spacers can be used for various applications in horizontal positions in pre cast or inside concrete. Recommended installation 50cm interval.



## Normfix Spacer (NF)

Product Code	Item Description	Concrete Cover (mm)	For Steel Bar Diameter (mm)	Packing Quantity Per Bag (pcs)
<b>MBA-NF25</b>	Normfix H/D Spacer 25	25	8-24	500
<b>MBA-NF30</b>	Normfix H/D Spacer 30	30	8-24	500
<b>MBA-NF40</b>	Normfix H/D Spacer 40	40	8-24	500
<b>MBA-NF50</b>	Normfix H/D Spacer 50	50	8-24	250
<b>MBA-NF60</b>	Normfix H/D Spacer 60	60	16-36	200
<b>MBA-NF75</b>	Normfix H/D Spacer 75	75	16-36	150

**Application** The wide stands prevent the tipping of the element usage area ranges from radial foundation to heavy duty lying and beams. The durability of our normfix is undeniable.



## Wheel Spacer (MW)

Product Code	Item Description	Concrete Cover (mm)	For Steel Diameter	Packing Quantity per Bag (pcs)
<b>MBA-MW20</b>	Wheel Spacer MW 20	20	4-13	1,000
<b>MBA-MW25</b>	Wheel Spacer MW 25	25	4-16	1,000
<b>MBA-MW30</b>	Wheel Spacer MW 30	30	4-20	500
<b>MBA-MW40</b>	Wheel Spacer MW 40	40	4-20	250
<b>MBA-MW50</b>	Wheel Spacer MW 50	50	4-22	250
<b>MBA-MW60</b>	Wheel Spacer MW 60	60	8-32	150
<b>MBA-MW75</b>	Wheel Spacer MW 75	75	8-32	100

**Application** Wheel Spacer was designed to use in vertical and horizontal reinforcements and it gives the required distance between formwork and rebar.





## Modern Universal Spacer (MUS)

Product Code	Item Description	Concrete Cover (mm)	For Steel Diameter	Packing Quantity per Bag (pcs)
<b>MBA-MUS20</b>	Modern Universal Spacer 20	20	4-12	2,000
<b>MBA-MUS25</b>	Modern Universal Spacer 25	25	4-12	1,000
<b>MBA-MUS30</b>	Modern Universal Spacer 30	30	4-12	1,000
<b>MBA-MUS40</b>	Modern Universal Spacer 40	40	6-20	500
<b>MBA-MUS50</b>	Modern Universal Spacer 50	50	6-20	500
Application	Universal wheel spacer is the most extensively used circular spacer for precast and on site concrete applications. Wide contact surface and foot members increase load capacity and prevent tipping.			



## 4 Leg Chair Spacer (4LCS)

Product Code	Item Description	Concrete Cover (mm)	For Steel Diameter	Packing Quantity per Bag (pcs)
<b>MBA-4LCS25</b>	4 Legs Chair Spacer 25	25	4-12	500
<b>MBA-4LCS30</b>	4 Legs Chair Spacer 30	30	4-12	500
<b>MBA-4LCS40</b>	4 Legs Chair Spacer 40	40	6-20	500
Application	The 4 Leg chair spacer is suggested for all kinds of slabs, on site casting, prefabricated, tilt ups, post tension and concrete finish. (comes in various colors)			



## Shimpads (SHP)

Product Code	Item Description	Thickness Sizes mm	Packing Quantity per Bag (pcs)
<b>MBA-SHP7002</b>	Shimpad 70 x 70 x 02	02	1,000
<b>MBA-SHP7003</b>	Shimpad 70 x 70 x 03	03	500
<b>MBA-SHP7005</b>	Shimpad 70 x 70 x 05	05	500
<b>MBA-SHP7010</b>	Shimpad 70 x 70 x 10	10	250
<b>MBA-SHP5002</b>	Shimpad 50 x 50 x 03	03	1,000
<b>MBA-SHP5005</b>	Shimpad 50 x 50 x 05	05	1,000
<b>MBA-SHP5010</b>	Shimpad 50 x 50 x 10	10	500
<b>MBA-USHP7002</b>	U - Shimpad 70 x 70 x 02	02	1,000
<b>MBA-USHP7003</b>	U - Shimpad 70 x 70 x 03	03	1,000
<b>MBA-USHP7005</b>	U - Shimpad 70 x 70 x 05	05	1,000
<b>MBA-USHP7010</b>	U - Shimpad 70 x 70 x 10	10	1,000
Application	Used for alignment and leveling of heavy section steel plate and pre cast concrete sections. Available as plain flat section or horseshoe to fit around connecting bolts.		



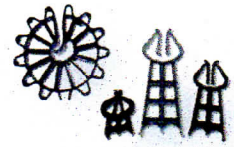
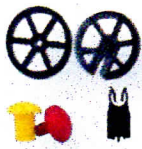

## Pile Cage Spacers

Product Code	Item Description	Sizes Ø mm	Concrete Cover	For Steel dia	Packing Quantity per Bag (pcs)
MBA-OPS75	Pile Spacer 75mm Open	75	75	12	90
MBA-CPS75	Pile Spacer 75mm Closed	75	75	12	80
MBA-CPS100	Pile Spacer 100mm Closed	100	100	16	50
MBA-CPS125	Pile Spacer 125mm Closed	125	125	16	25
Application	Pile cage spacers are attached to the external steelwork of pile cages to ensure correct spacing of the steelwork from the shuttering, and the required concrete cover is maintained over the length of the pile. Pile cage spacers are circular and of high strength to ensure smooth entry of the reinforcing cage without distortion. The pile cage spacers are available as thread-on or clip-on versions, with concrete cover options of 70mm or 45mm.				

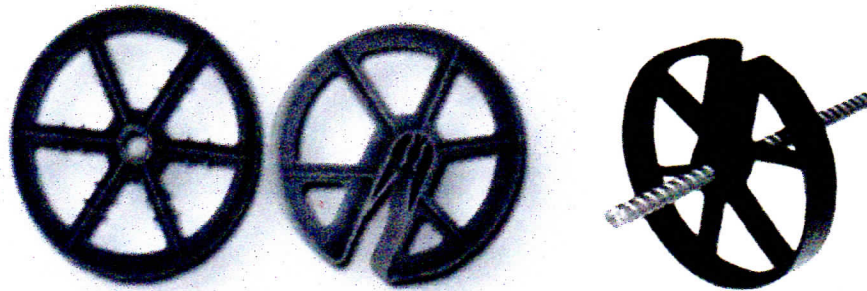

## Clampfix chair spacer (MCL)

Product Code	Item Description	Concrete Cover (mm)	For Steel Bar Diameter (mm)	Packing Quantity Per Bag(pcs)
MBA-MCL20	Clampfix M/D chair spacer20	20	8-18	500
MBA-MCL25	Clampfix M/D chair spacer25	25	8-20	500
MBA-MCL30	Clampfix M/D chair spacer30	30	8-20	500
MBA-MCL50	Clampfix M/D chair spacer50	50	8-20	500
MBA-MCL75	Clampfix M/D chair spacer75	75	8-20	250



**Clampfix** is a sturdy general purpose clip-on spacer used in all types of applications, found in precast yards and on site.



## TECHNICAL DATA FOR PLASTIC SPACER CHAIRS AND WHEELS

To achieve the required cover to reinforcing steel according to BS 7973-1-2001 and ACI SP-66, chairs or wheels must be used according to a standard method of application. The spacers manufactured by MBA are of the plastic "clip on" type, in wheel or chair form. Spacers are available to give cover to a range of bars in nominal steps, typically 20, 25, 30, 40, 60, and 75mm. Plastic Chair Spacers MC are used for spacing of lower reinforcing in slabs and beams and classified under category (L). Plastic Chair Normfix are used for spacing heavy reinforcing steel in slabs and beams and classified under category (H). The MW wheel spacers are for vertical reinforcing steel in walls and columns.

To ensure the correct positioning of the steel, spacers must be placed according to the recommended pattern and the load capacity of the individual chair at the allowable deflection, point load per spacer:

$$MC=0.40 \text{ KN} - \text{Normfix: } 6 \text{ KN} - MW = 0.60 \text{ KN}$$

Spacers are marked with type, concrete cover, and bar size range.

CHAIR SPACING FOR SLAB CONSTRUCTION ( $d$  = bar diameter)

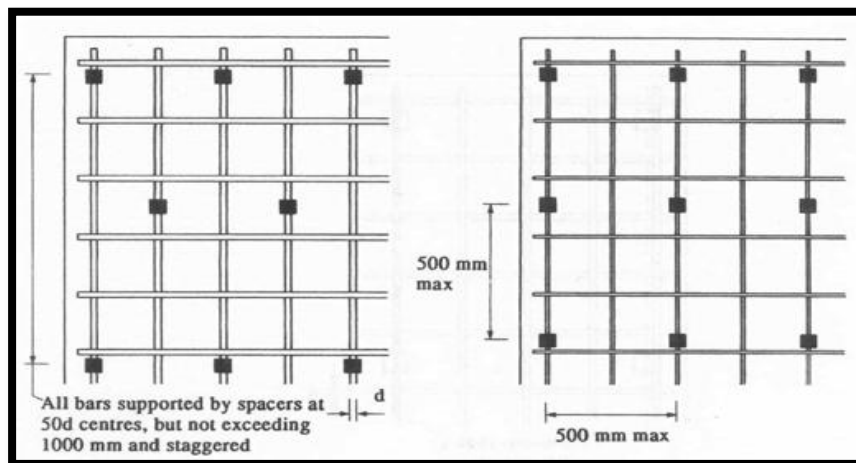

WHEEL SPACING IN COLUMN CONSTRUCTION ( $d$  = bar diameter)

Spacers to be fixed vertically to links at top, middle and bottom of each lift, at centers not exceeding  $100 \times d$ .

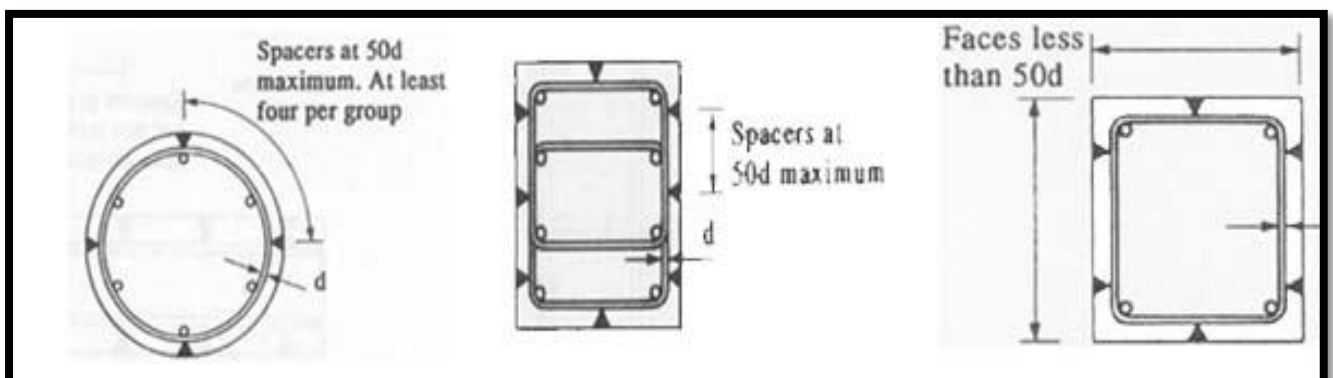



## Roof Tile Spacers

Product Code	Item Description	Packing Quantity per Bag (pcs)
<b>MBA-RoofTile</b>	Roof Tile Spacer	200
Application	It provides equal height and joint section at the erection of square ties laid over insulating material at open roofs to protect them against conditions of the nature.	

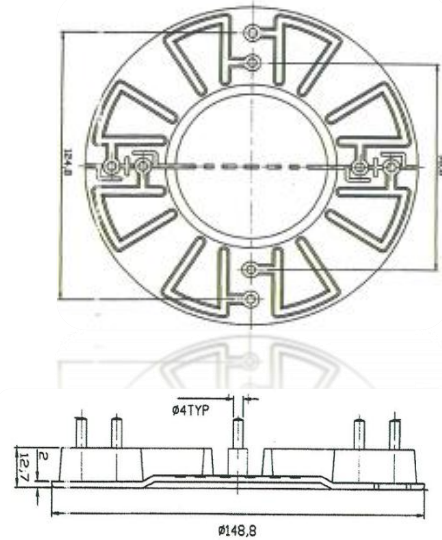

## Hollow Core Cap (HCC)

Product Code	Item Description	Slab Height	Packing Quantity per Bag (pcs)
<b>MBA-HCC150</b>	Hollow Core Cap 150	150	500
<b>MBA-HCC200</b>	Hollow Core Cap 200	200	400
<b>MBA-HCC265</b>	Hollow Core Cap 265	265	250
<b>MBA-HCC320</b>	Hollow Core Cap 320	320	150
<b>MBA-HCC400</b>	Hollow Core Cap 400	400	100
<b>MBA-HCC500</b>	Hollow Core Cap 500	500	100
Application	A cap oval or circle in shape used to capped it in both ends of the pre-cast slabs to prevent foreign materials from blocking up the hole opening reverse for installation of conceal service pipes or wires in need. Also prevent concrete from entering the hollow section mean for reduce weight loading on buildings.		

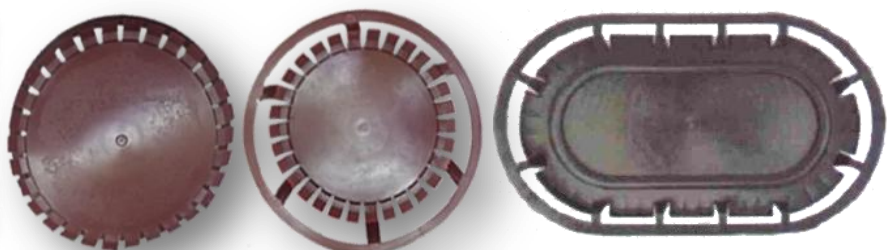



## Pipe Spacer (PS)

Product Code	Item Description	Packing Qty. Per Bag (Pcs)
<b>MBA-PS110B</b>	Pipe Spacer 110mm Base	40
<b>MBA-PS110IN</b>	Pipe Spacer 110mm Intermediate	40
<b>MBA-PS160B</b>	Pipe Spacer 160mm Base	40
<b>MBA-PS160IN</b>	Pipe Spacer 160mm Intermediate	40
<b>MBA-PS200B</b>	Pipe Spacer 200mm Base	40
<b>MBA-PS200IN</b>	Pipe Spacer 200mm Intermediate	40
Application	Designed as pipe spacers used to align installed pipes.	

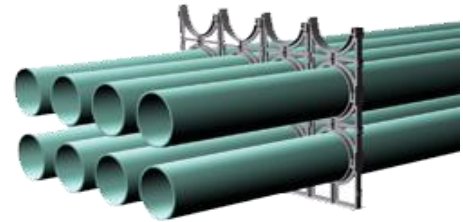
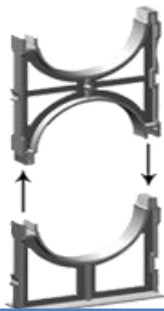

## PVC Cone (CONE)

Product Code	Item Description	Color	Sizes Ø mm	Pipe Ø mm	Packing Quantity per Bag (pcs)
<b>MBA-CONE22</b>	PVC Cone 22mm	Black	22	25	1,000
<b>MBA-CONE26</b>	PVC Cone 26mm	Black	26	32	1,000

Application Support cones are used at the end of the PVC tube and can be easily extracted after removal of the formwork

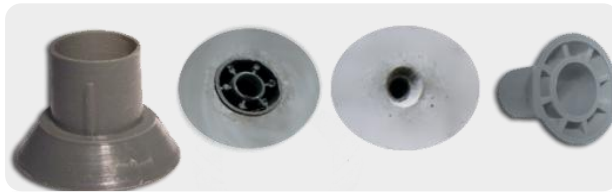

### PVC Sleeves

Nominal Size (mm)	Inside Diameter	Wall Thickness (mm)
20	17.4	1.4
25	22.1	1.6
32	26.6	2.5
38	33.0	2.5
50	43.2	3.2

**Standard Color :** All PVC sleeves are White or Black in color.

**Application** ..De bonding sleeves for Tie Rod Pipe  
 ..De bonding sleeves to cover the reinforcement bar at the top of reinforced concrete cast insitu piles.





## PVC Chamfer

Product Code	Item Description	Size (mm)	Length (m)	Packing Quantity per Bundle (pcs)
<b>MBA-PCF1002</b>	PVC Chamfer 10mm x 10mm x 2m	10	2	100
<b>MBA-PCF1502</b>	PVC Chamfer 15mm x 15mm x 2m	15	2	50
<b>MBA-PCF2002</b>	PVC Chamfer 20mm x 20mm x 2m	20	2	50
<b>MBA-PCF2502</b>	PVC Chamfer 25mm x 25mm x 2m	25	2	50
<b>MBA-PCF3002</b>	PVC Chamfer 30mm x 30mm x 2m	30	2	50

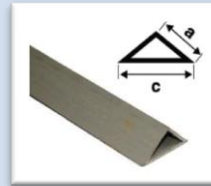
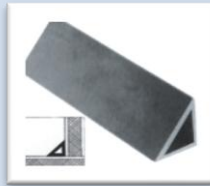

<b>MBA-CFN1002</b>	CFN 10mm x 2m	10	2	50
<b>MBA-CFN2002</b>	CFN 20mm x 2m	20	2	50

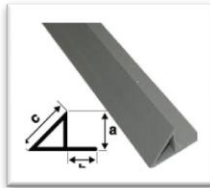

**Application** Impact resistance PVC figuration for chamfering corners for beams and it prevents the leaking out of the mould. CFN is nailed in the corners by flange and can be removed afterwards.





## Rebar Protection Cap (RBC)

Product Code	Item Description	Color	Sizes Ø mm	Packing Quantity per Bag (pcs)
<b>MBA-RPC0816</b>	Rebar Protection Cap Yellow 8-16	Yellow	8-16	250
<b>MBA-RPC1632</b>	Rebar Protection Cap Yellow 16-32	Yellow	16-32	250
Application	Act as a safety protection cap for the steel bar ends. Made of plastic which is durable and highly visible to prevent injuries from protruding rebars. Rebar protection cap are just one item in the market today that fit directly with OSHA.			

**Note: We can produce any color as per your requirement.**



## POLYMIDE SLEEVES



Product Code	Item Description	Color	Sizes Ø mm	Packing Quantity per Bag (pcs)
<b>MBA-PS06</b>	Polymide Sleeve 06	White	06	10,000
<b>MBA-PS08</b>	Polymide Sleeve 08	White	08	10,000
<b>MBA-PS12</b>	Polymide Sleeve 12	White	12	10,000
<b>MBA-PS16</b>	Polymide Sleeve 16	White	16	10,000
<b>MBA-PW08</b>	Polymide Washer 08	White	08	10,000
<b>MBA-PW12</b>	Polymide Washer 12	White	12	10,000
<b>MBA-PW16</b>	Polymide Washer 16	White	16	\10,000



## Concrete Movement Joints Accessories

### Dowel Bar Sleeves

To provide an efficient method of de-bonding the steel dowel bars.

### Dowel Bar End Caps

A quick applied cap supplied with compressible filler. It is designed to allow movement during expansion when fitted to de-bonding sleeves.

### Application

Contraction and expansion joints in concrete floors in conjunction with designed dowel bars.

### Material Specification

The de-bonding sleeve is made of PVC compound in black color extruded and cut accurate designed lengths. Expansion caps are made high density polyethylene with compressible filler made from low density polyethylene. The sizes are shown below:

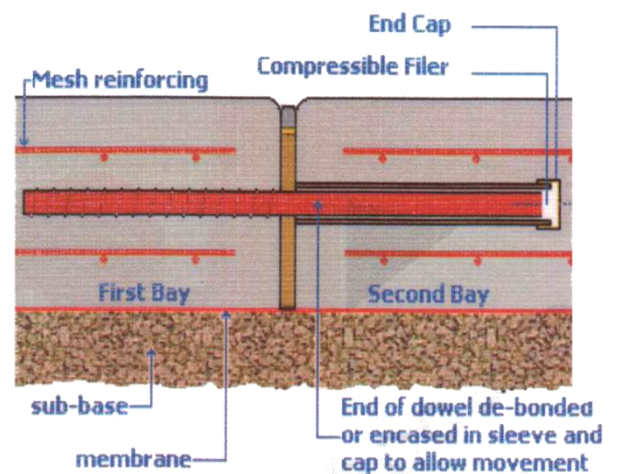

Sleeve Outside Dia (mm)	Dowel Bar Dia (mm)	Sleeve Part No.	Dowel Bar Dia (mm)
20	16	RCM 20	16
25	20	RCM 25	20
32	25	RCM 32	25
40	32	RCM 40	32
50	40	RCM 50	35~40



## MBA Monolithic Paving System

### The product is designed to:

- Create a monolithic paving surface providing high wind uplift resistance
- Carry the lead load of paver surface.
- Perfect final leveling from 22mm to 30mm.

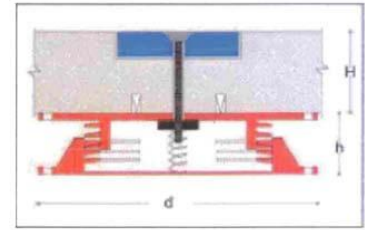

### To meet the above targets, MBA monolithic paving system is consisting of:

1. High density polyethylene top plate 70x70x10mm with a middle hole 9mm.
2. Jack support with inside threading allows movements in height to the nearest millimeter.
3. Countersunk bolt M08 with different lengths according to paver thickness.
4. Galvanized spring nut M08.

### Specifications and dimensions

Item Description	Size	Color	Packing
<b>Top Plate</b>	70mm x 70mm x 10mm	Black, other colors possible	250 / bag
<b>Support Jack</b>	d=150mm & h=(22-30)mm	Black	20 / cartoon
<b>Countersunk Bolt</b>	M08 XL	Black mill finish, S steel bright finish	Varies
<b>G.I. Spring Nut</b>	M08	Silver	50 / cartoon

### Materials

- Top plate and support jack material certificate is shown below
- Countersunk bolt is mill fish, mild steel. S. steel A4 bolt is supplied on request
- Spring nut is zinc plated mild steel.

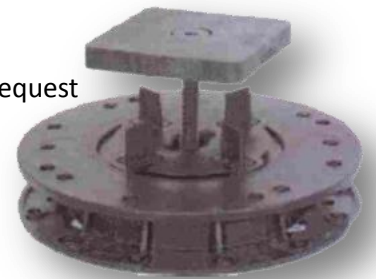

### Raw Material: High Density Polyethylene HDPE B 5429A

Physical Properties	Value	Unit	Test Method
Material Density	0.954	g/cm	ASTM D-1505
Stress Crack Resistance F50 (100% 1 gepal, 50c)	55	Hrs	ASTM D-1693 B
Tensile Strength @ Yield	27(3920)	Mpa (psi)	ASTM D-638
Tensile Strength @ Break	32(4640)	Mpa (psi)	ASTM D-638
Tensile Elongation @ Break	850	%	ASTM D-638
Flexural Modulus	1,200,00		ASTM D-

\*UV stabilizer is added to the above.



## Technical Data Sheet

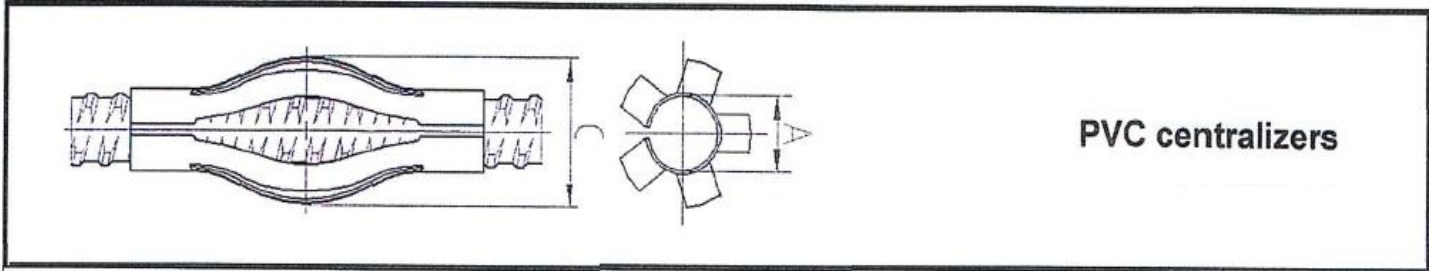

### DIMENSIONS

Code	Bar Diameter "A" in mm	External Measurement Diameter "C" in mm
MBC20	20	70
MBC25	25	90
MBC32	32	140
MBC40	40	150
MBC50	50	160

### MATERIALS USED

Material:	UPVC According to DIN 8062
Density:	about 1,42 g/cm <sup>3</sup>
Yield Point:	> 52 Mpa
Yield Point Elongation:	> 52 Mpa
Elastic Module:	> 3300 Mpa
Vicat HDT:	> 88 °C
Linear Thermal Expansion:	Circa 0.06 mm/m°C
<b>Color Gray, Orange &amp; Black</b>	



## PVC CERAMIC TILE TRIM

### Quick Details

- Type: Tile Accessories
- Place of Origin: **Modern Building Accessories Factory MBA** ( Qatar )
- Model Number: 8mm -9mm – 10 mm
- Tile Accessory Type: Tile Trims
- Material: PVC
- Usage: External Wall



### Specifications

The PVC tile trim material rigid PVC

Color: According to the customer requirement.

We could produce every size you like (8mm/ 9mm /10 mm)

This PROFILE replaces the traditional mitred joint systems, not used anymore. Against the weakness and breakage of the wall tile corners; these tile trims allow you .to protect and enhance external tile corners and edges

The above PVC Profiles can be used for all kind of tile corners, kitchen, bathrooms; .etc. tops finishes and endings, getting always a perfect finish

This is the easiest way to protect, to decorate and to reduce high cost of old systems.

**Length:** generally 2.5mtr. Or according to your requirement

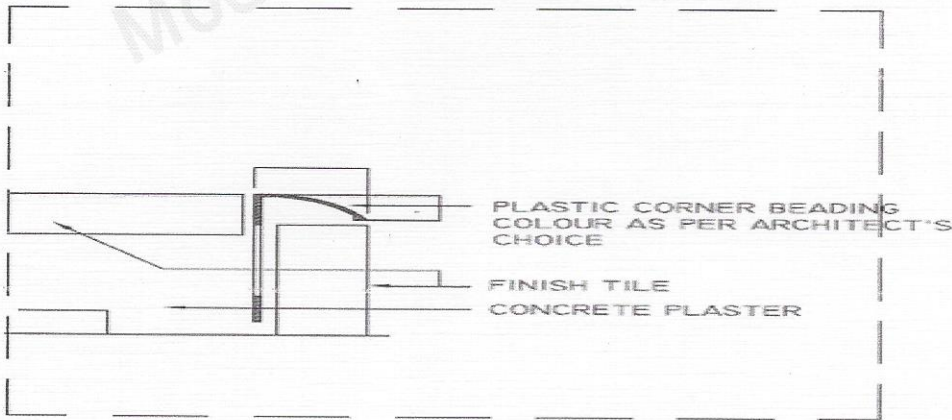

**Office :**  
P.O.Box.: 15756 - Doha - Qatar  
Tel. : (+974) 44504959 - (+974 ) 44504949  
Fax : (+974) 44504957  
**Factory :-**  
Tel.: (+974) 44114597 - Fax : (+974) 44114598



**المكتب :-**  
ص.ب: 15756 - الدوحة - قطر  
هاتف: 4450-4959 (+974) - 4450-4949 (+974)  
فاكس: 4450-4957 (+974)  
**المصنع :-**  
هاتف: 44114597 (+974) - فاكس: 44114598 (+974)